



# City of Lake Oswego PUBLIC NOTICE Pending Tree Cutting Permit

Name of applicant Diane Hedder  
Craig Briggs Tree Permit No. TR 10-0392  
Applicant's Phone Number 503 636 8445 or cell 503 956 6644  
503 635-8445

I, Diane & Hedder and  
Craig M Briggs do certify that I am, or I represent, the party requesting a  
Print your name  
permit to cut 1 50' x 10 Trunk Apple Tree 3' Diameter -> 4x1' trunks at 4 feet trees on  
Size, number, and type of trees to be removed  
property located at 297 & 305 G Avenue (on the line) Pursuant to LOC 55.02.082,  
Address or location

this notice has been prepared to notify the neighborhood association of the pending removal. I will mark the proposed trees with yellow tagging tape and post a public notice sign on the subject property prior to your receipt of this notice. You may submit comments on the application in writing within 14 days of the date of this notice. I understand that I am responsible for maintaining the notice and marking during the entire 14 day comment period.

*Diane Hedder*

*Craig M Briggs*  
Signature

Notice Date: 6/3/10

Neighborhood Association: First Addition Forest Hills Map & Tax Lot: 21E 03 DA 00302

REMINDER: A tree cutting permit is required to remove trees larger than 5 inches in diameter. Topping trees is prohibited in the City of Lake Oswego.

City of Lake Oswego Community Development Department 503-635-0290

# TREE REMOVAL QUESTIONNAIRE

The City's Tree Code encourages tree preservation and protection because trees are a valuable community resource that contribute significantly to Lake Oswego's quality of life.

The City's Tree Code requires a Type II permit for the following situations:

- Removal of a tree on a residential property (that is occupied by a single family dwelling) that is larger than 10" in diameter or trees that are beyond those allotted through the Type I process.
- Removal of any tree(s) that is 5" or greater in diameter on property other than single family residential or any vacant site.

020-41-45  
A Type II permit may **only be approved** if you can demonstrate through the required application materials that all of the following criteria are satisfied. **Please be as thorough as possible with your answers.** City staff will visit the site, review this application, and make a decision regarding this request. You will be notified if additional information is needed.

## Please answer the following questions:

Removal of trees under a Type II permit is only allowed for two purposes: landscaping or constructing a development that is approved or allowed by applicable development regulations. (Note: If the removal is for purposes of development, you must meet on-site with the City arborist prior to submitting this application. Call 503-635-0290 to schedule this meeting.)

1. Please explain how the removal of the tree(s) relates to one of the two allowed purposes. Please attach a landscaping or development plan.

*We wish to replace this 20' apple tree with a new fruit tree - probably apple or cherry - that can produce fruit, be pruned yearly, stay below 25' or so, not catch on fire burning on high tension lines, and improve solar access to the south to displace carbon burning for heat and electricity.*

2. Will removal of the tree(s) have a significant negative impact on erosion, soil stability, flow of surface waters, protection of adjacent trees, or existing windbreaks? (Note: A simple yes or no response is not adequate. Describe details of your lot such as number of trees, tree sizes, slope of land, and trees on adjacent lots and in the neighborhood.)

*The area is flat - no erosion or soil stability issues. It will help adjacent trees - especially high producing plum. Our lots are big 50x300 and each is 1/3 solid forest plus many other large trees (see site plan) Back lot slopes into Tryon Creek State Park.*

3. Will removal of the tree(s) have a significant negative impact on the character, aesthetics or property values of the neighborhood? (Note: A simple yes or no response is not adequate. Describe the tree character of your neighborhood and how this tree removal would impact that character.)

*We think that with a 2" fruit tree replacement that the character and property values will improve or at least stay the same. In addition, we have lots of tall fir trees and medium deciduous. Replacement will be medium deciduous - looks good.*

4. Is removal of the tree(s) for the sole purpose of providing or enhancing views?

*NO*

The City may approve a tree removal request if it is demonstrated that no reasonable alternative exists in order to allow the property to be used as permitted in the zone. In making this determination, the City may require alternative site plans or placement of structures (including alternative foundation designs) or alternative landscaping design that incorporates existing trees.

Mitigation for the removal of each tree is required as a condition of approval of a permit, if approved.

MATTI DRIBBS LOT 1 705 G AVENUE NEAR GREENWOOD SYSTEM IS OWNED BY CITY OF LITTLE ROCK IN PROCESS OF REDEVELOPING PLOTS TO CONSUMERS

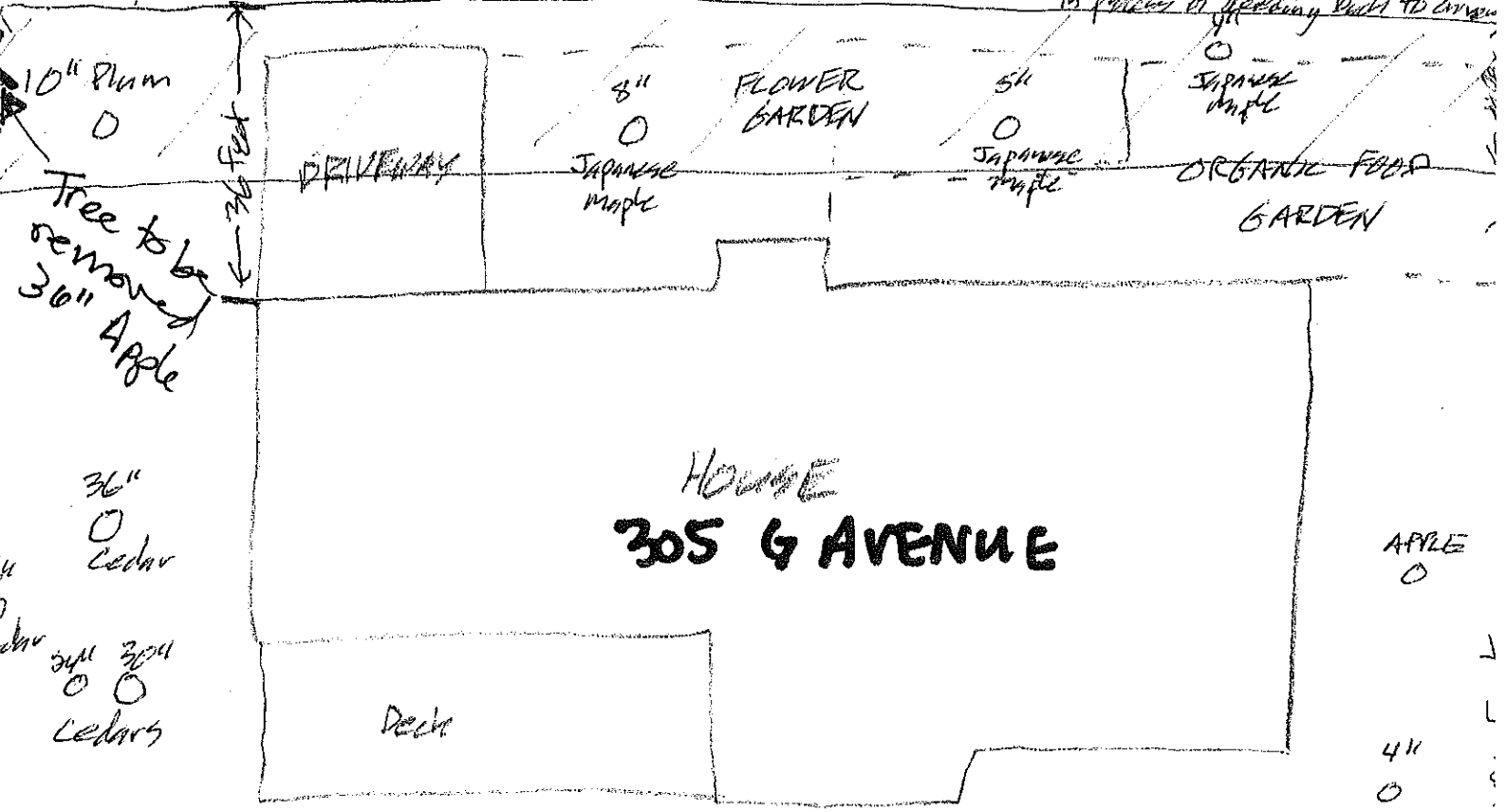

10" Plum  
 Tree to be removed  
 30" Apple

36" Cedar  
 30" Cedar

APPLE  
 4" ASH  
 12" FIR

90 Native Plants + Trees  
 on 8-12" of ground weed strips  
 Transition zone to forest

mostly CEDARS  
 SLOPED FULL FOREST  
 35-40 Trees 2-4' in diameter  
 20-40 Trees Smaller

VIANE HOLLOWAY & NEPT CURTIS LUI 071 5 AVENUE now owned by City LLC  
in process of deciding which to remove

8"  
O  
Plum

12"  
O  
Plum

7" trunk 36"  
3 FT Apple  
Apple  
60 FT tall

FRUIT TREE

THIS IS THE TREE  
WE WANT TO CUT DOWN

11"  
O

12"  
O

4"  
O

11"  
O  
R

11"  
O  
R

11"  
O

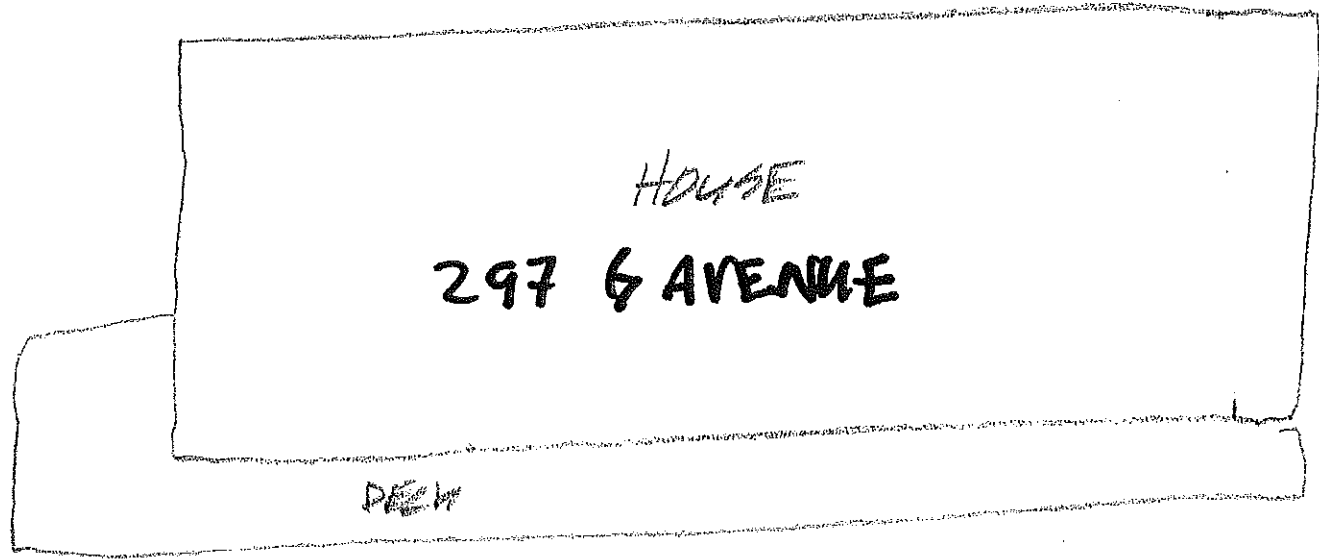

SLOPED  
FULL  
FOREST

25-40 trees 2-4' in diameter  
20-30 trees smaller



# Tree Removal Application

Permit No. TR 10-0392  
Fee: \$ 146.00  
Receipt No. 367581  
Date: 6/2/10

Applicant: Dianne K Hoobler  
Craig M Briggs Phone: 503 635 8445

Address of Tree Removal: 347 and 305 G Avenue (on line) Lake Oswego OR 97034

Property Owner: to original owners Forth Phone: 503 956-6646 (cell) Hoobler  
Dianne Hoobler and Craig M Briggs

Number, Size (Trunk Diameter), and Type of Tree(s) to be Removed: 36" Diameter Apple

Reason for Removal: Apple has caught on fire/pruning, huge lean & desire to replace with usable fruit trees, trunks falling - no way to top of trunk without killing the tree

I agree to comply with Lake Oswego Code, Chapter 55, regarding tree removal. I grant permission to the City of Lake Oswego for employees to enter the above property to inspect the trees requested for removal and investigate any trees that may appear to have been already unlawfully removed. I agree to restrain any dog(s) on inspection day.

Signature of Property Owner (required)  
Dianne K Hoobler

Signature of Applicant (if different)  
Craig M Briggs

The City Manager must sign for trees located on public property. - Transfer of this lot strip purchased Forth by the City to expand G Avenue BKR to owners is in process.

- TYPE I Submit: (1) Removal site plan (8½ x 11")
- TYPE II \* Submit: (1) Removal site plan (8½ x 11"), (2) Questionnaire, (3) Mitigation plan  
To Do: (1) Mark trees with yellow ribbon, (2) Post sign, (3) Stake building envelope & driveways if new construction is proposed
- DEAD Submit: (1) Removal site plan (8½ x 11"), (2) Printed photograph of tree  
Deciduous trees require a site visit by staff between November 1<sup>st</sup> and April 15<sup>th</sup>. To Do: Mark the tree(s) with yellow ribbon if a site visit is required.
- HAZARDOUS Submit: (1) Removal site plan (8½ x 11"), (2) Printed photograph of tree, (3) Certified arborist's report, (4) Hazard Evaluation Form completed by certified arborist  
To Do: (1) Mark trees with yellow ribbon
- EMERGENCY Submit: (1) Removal site plan (8½ x 11"), (2) Printed photographs demonstrating extreme lean of tree and soil heaving upwards at the base
- VERIFICATION \* (Prior approval) Submit: (1) Removal site plan (8½ x 11"), (2) Mitigation plan  
To Do: (1) Mark trees with yellow ribbon, (2) Stake building envelope & driveways

\* Building Permits will not be issued prior to tree removal or tree protection inspection and approval.

City Staff to Fill Out:  
Intake Staff JH Zone R7.5 Tax ID 21E03DA00302 Due Date 6/17/10  
Neighborhood Association First Addition / Forest Hills  
Planning or Building File # \_\_\_\_\_ Mitigation Plan Approved/Denied \_\_\_\_\_  
Removal Approved/Denied \_\_\_\_\_ Decision Staff \_\_\_\_\_

## Mitigation Plan for Tree Removal at 297/305 G Avenue

- 1) We have enlisted the advise of arborist James Kinder of Green Options Tree Care. His advice is that the tree cannot be topped or trimmed back to fruit picking level. It will kill the tree. The apple tree is 60+ feet tall and has caught on fire twice leaning on high tension lines. He suggests calling PGE to take down trunks/branches of the tree that hang over the power lines, then the various trunks of the tree can be taken down in pieces safely.
- 2) James Kinder suggests planting a couple 2 inch plus diameter hemlock trees in the forest parts of the lots behind each house. He thinks they would be very beneficial to the forest there. There are a few open canopy areas. We can also plant another good size fruit tree in this spot that we can regularly prune to 20 feet or so to avoid the same problem in the future.
- 3) Before we can proceed with this tree removal plan, we need final action on the transfer back to both of our lots----297 G and 305 G---the 20 foot strip of land given to the City of Lake Oswego for \$1 many years ago when the City was considering widening G Avenue. Ours are the only two lots with 20 foot strips pulled by the City. The apple tree that we want to cut is currently on that City "donated" property. We would like to give the City back the \$1 and then take care of the tree on our dime. One bid from Drendel's Tree Service was \$5000 to take the tree down.
- 4) Both of our lots contain 50-100 other large trees each because of their size. We both think restoratively in our everyday living. Jeff Curtis ran Trout Unlimited for many years, and Matt Briggs has made a movie on how to Live Lighter on the Planet. We have organic gardens, flower gardens, and large native plant transition zones to the forest. But this old apple tree (we call it the apple missile tree) has caught on fire twice, cannot bear good fruit, shades other good fruit trees, and blocks direct south solar access for both houses. We would like to take it down and replace it with several trees take it's place and then expand our solar collection to eliminate carbon energy burning from both of our houses as much as possible. We think this is a good argument that can increase tree productivity, replace over time tree mass and lower carbon footprints with better solar access to the south.